

**ALTA COMMITMENT FOR TITLE  
INSURANCE EXHIBIT "A"  
LEGAL DESCRIPTION**

ISSUED BY  
Stevens County Title & Escrow

**File No.: 25-41716-SCT**

Parcel 1831229:  
The NE1/4 of the NW1/4 in Section 34, Township 33 North, Range 38 East, W.M., in Stevens county, Washington.

Abbreviated Legal: NE1/4 NW1/4, 34-33-38

Tax Parcel No.: 1831229

Property Address: 25XX Burgess Road, Addy, WA 99101

Seller: \_\_\_\_\_

Buyer: \_\_\_\_\_

Seller: \_\_\_\_\_

Buyer: \_\_\_\_\_

**The address shown above is provided for information only, as a convenience for the customer and is not included in the legal description to be insured. The Address was determined by public records and the Company assumes no liability for any inaccuracy of the address.**

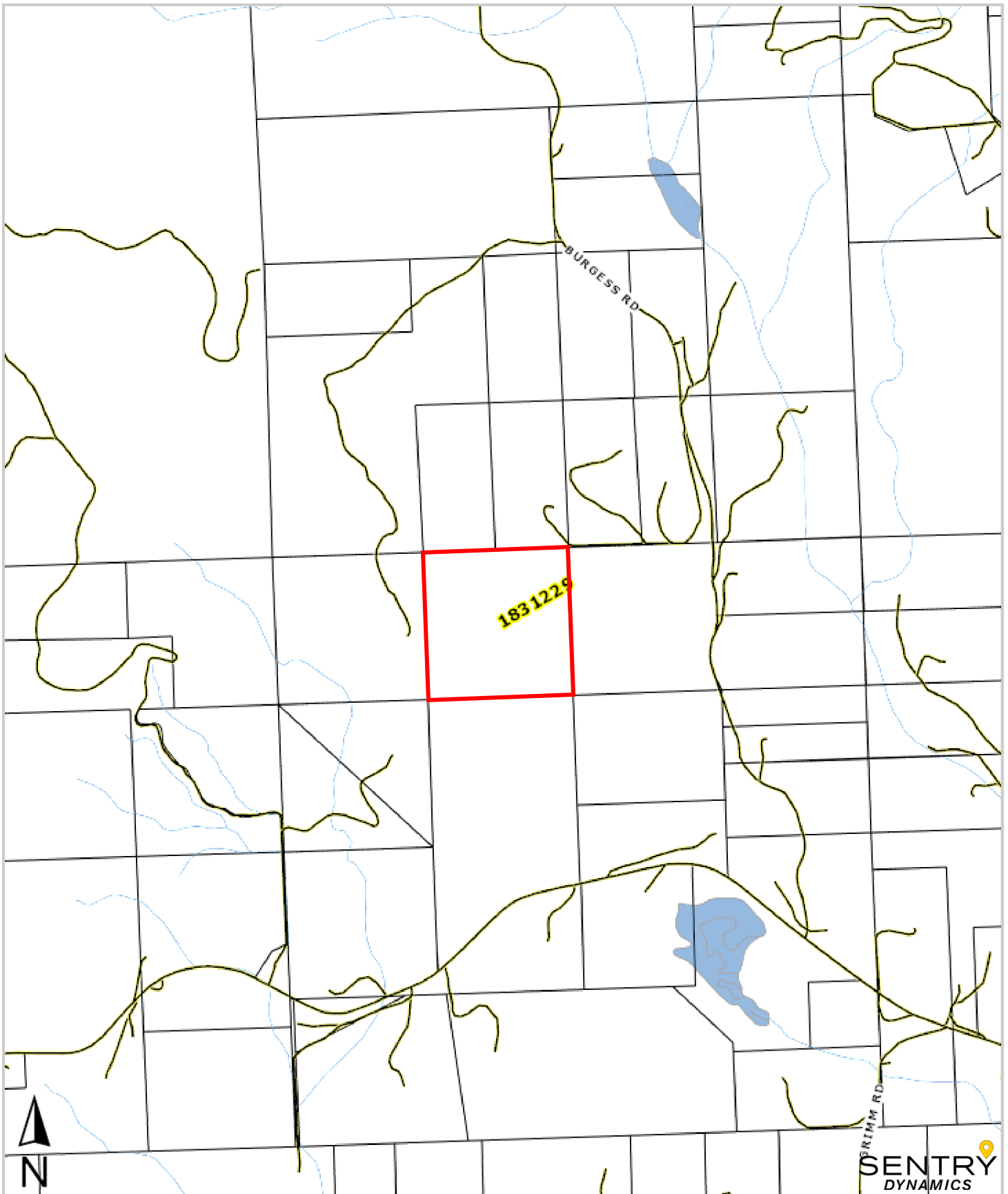

  
**STEVENS COUNTY**  
TITLE & ESCROW

This map/plat is being furnished as an aid in locating the herein described land in relation to adjoining streets, natural boundaries and other land, and is not a survey of the land depicted. Except to the extent a policy of title insurance is expressly modified by endorsement, if any, the company does not insure dimensions, distances, location of easements, acreage or other matters shown thereon.

  
**SENTRY**  
DYNAMICS