

NORTHEAST TRI COUNTY HEALTH DISTRICT
 AS-BUILT DRAWING - PERMIT # PT-11140

INSPECTION DATE 10/20/09 INSPECTED BY BH APPROVED: YES NO

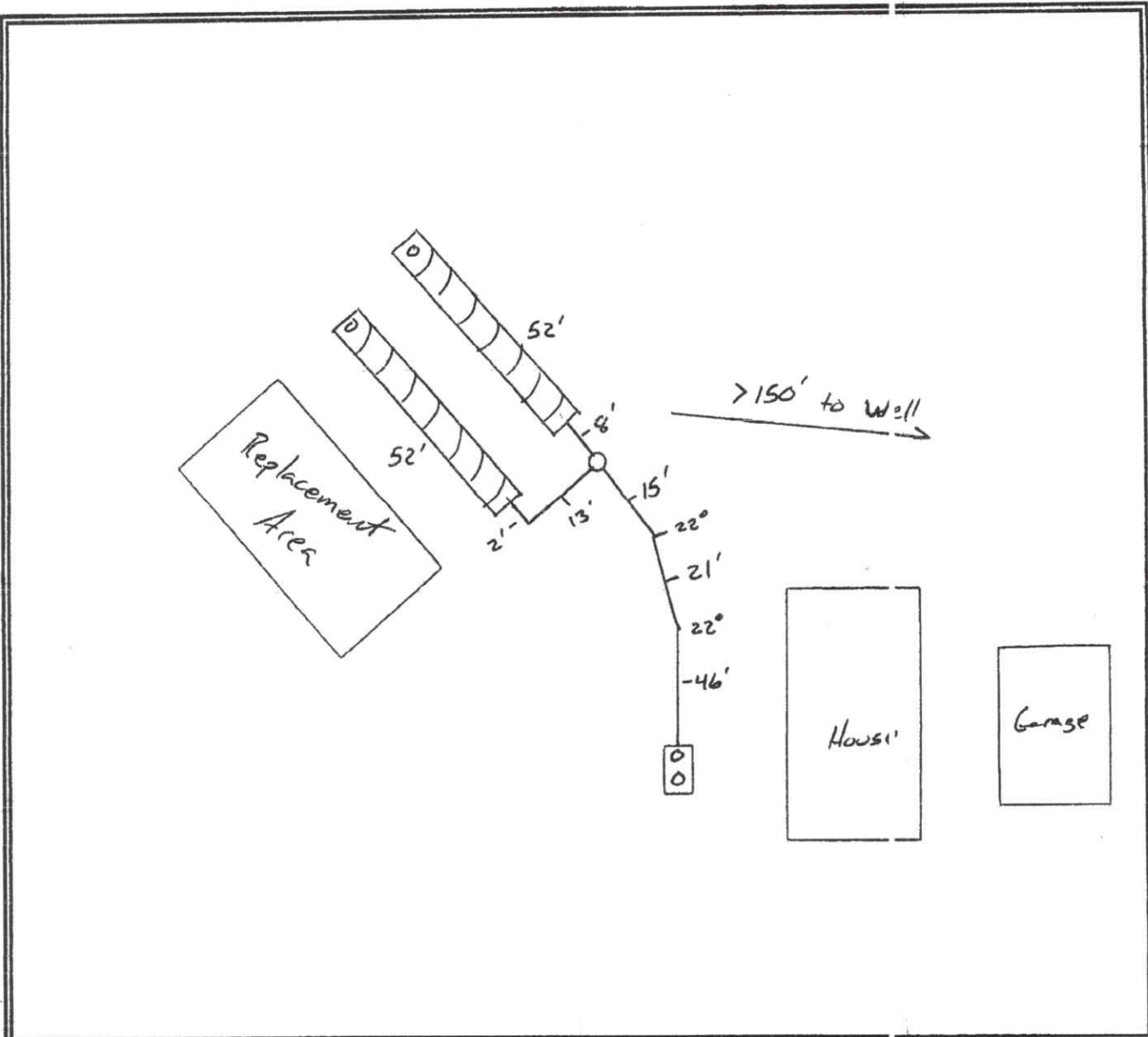

Installer Name Stotts
 Septic Tank Size 1000
 Drainfield Length 104
 Drainfield Depth 36

Pump Chamber Size _____
 Doses/Day _____ Gallons/Dose _____
 Squirt Height _____ Drawdown _____
 Pump Run Time _____

2009 12 11
ON 8968

19-37-32

NORTHEAST TRI COUNTY HEALTH DISTRICT
DIVISION OF ENVIRONMENTAL HEALTH

ON-SITE SEWAGE SYSTEM PERMIT # PT0011140

Richard Forest is hereby authorized to utilize a sewage disposal system at
N2 GL 2

Section: 19 Township: 37 Range: 32 Parcel #: 2-37-19-23-00020-00

in accordance with the plans and specifications approved by the District Health Officer or file in this office

Prior to any major repairs, replacements or alterations to the system a permit shall be obtained from the NorthEast Tri
County Health District (Division of Environmental Health).

This permit is issued and may be revoked by the NorthEast Tri County Health District Health Officer by authority of
WAC 246-272, and Northeast Tri County Health District Regulations established by the Board of Health pursuant to
RCW 70.05.

Additional permits from other jurisdictions or agencies may be necessary for this project. It is the responsibility of the
applicant to acquire said permit(s), and comply with all applicable rules, regulations and ordinances.



Date Issued: 08/11/2009

District Health Officer

PERMIT INSTRUCTIONS

STRUCTURE TYPE: Single-Family Residential

DFLF/BED DIMENSIC NS:133

NUMBER OF BEDROOMS: 1

TRENCH DEPTH (inches): 36

DESIGN FLOW (gal/day): 240

TENCH WIDTH (inches): 36

TYPE OF SYSTEM: Replacement

APPURTANENCES: Effluent Filter

SYSTEM DESIGN: Gravity

PUMP CHAMBER (y/t):

SEPTIC TANK CAPACITY (gal): 1000

PUMP CHAMBER GA LLONS:

REASON SYSTEM DESIGN:

SPECIAL PERMIT INSTRUCTIONS: 25% reduction of df allowed with use of graveles chambers; reducing df length
from 133' to 104'. Existing tank to be properly abandoned

FINAL INSPECTION DATE: 10/20/09 Initials: BHF

Stevens County Office	P.O.Box 270	Colville,	WA	99114	(509) 684-2262
Pend Oreille County Office	P.O. Box 490	Newport,	WA	99156	(509) 447-3131
Ferry County Office	P.O. Box 584	Republic,	WA	99166	(509) 775-3111