

**ALTA COMMITMENT FOR TITLE
INSURANCE EXHIBIT "A"
LEGAL DESCRIPTION**

ISSUED BY
Stevens County Title & Escrow

File No.: 26-43770-SCT

Parcel 1822100:

That part of the SE1/4 of the SW1/4 of Section 19, Township 33 North, Range 38 East, W.M., in Stevens County, Washington, lying North of Revision No. 1 of Cory Road No. 277 and East of Revision No. 2 of Sturman Road No. 175, also known as Truman Road No. 2654.

Abbreviated Legal: P/O SE1/4 SW1/4, 19-33-38

Tax Parcel No.: 1822100

Property Address: 3277 Old Baldy Road, Rice, WA 99167

Seller: _____

Buyer: _____

Seller: _____

Buyer: _____

The address shown above is provided for information only, as a convenience for the customer and is not included in the legal description to be insured. The Address was determined by public records and the Company assumes no liability for any inaccuracy of the address.

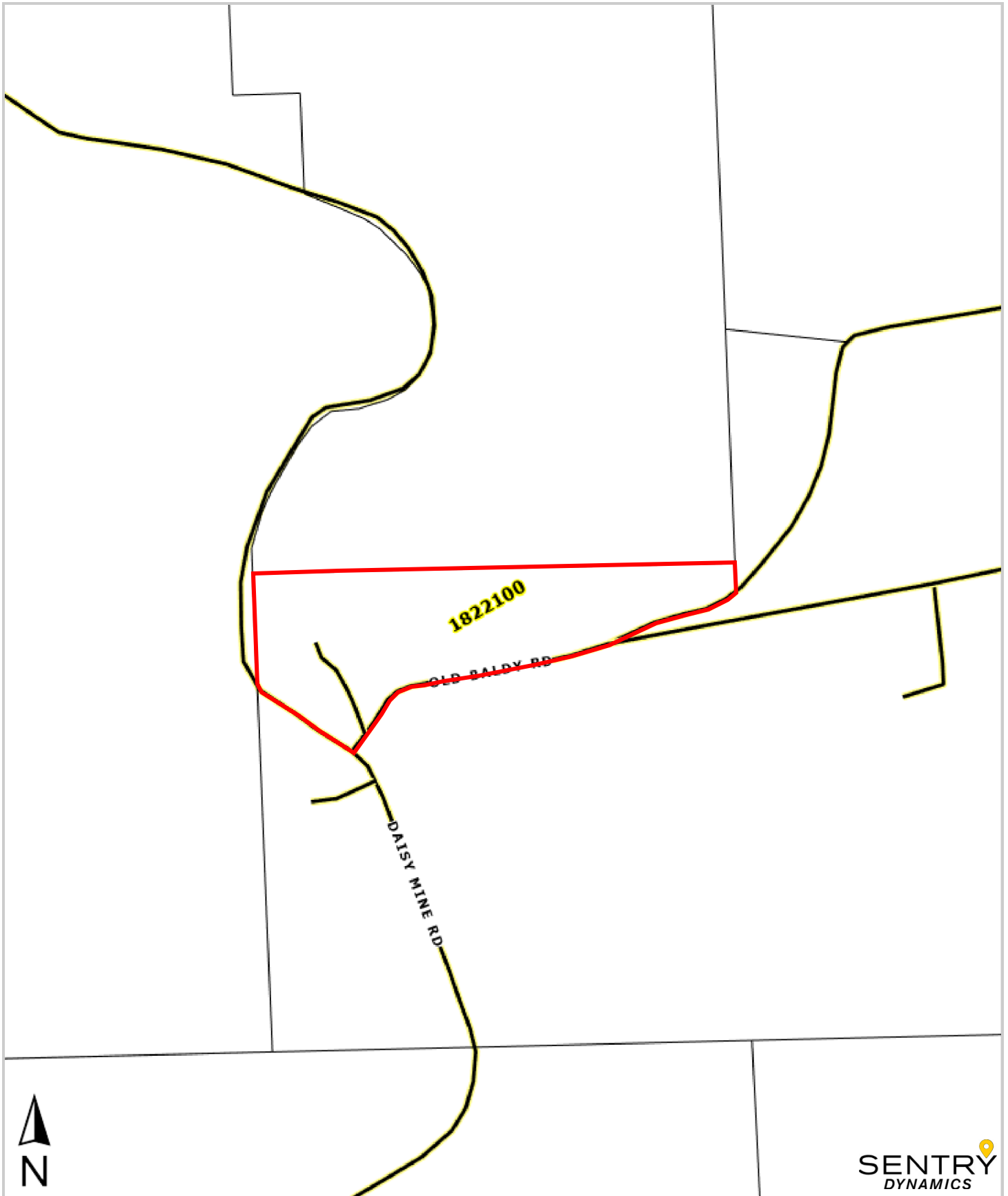

This map/plat is being furnished as an aid in locating the herein described land in relation to adjoining streets, natural boundaries and other land, and is not a survey of the land depicted. Except to the extent a policy of title insurance is expressly modified by endorsement, if any, the company does not insure dimensions, distances, location of easements, acreage or other matters shown thereon.