

**ALTA COMMITMENT FOR TITLE
INSURANCE EXHIBIT "A"
LEGAL DESCRIPTION**

ISSUED BY
Stevens County Title & Escrow

File No.: 26-44935-SCT

Parcel A 5156300:
The N1/2 of the N1/2 of the NE1/4 of the NW1/4 of Section 28, Township 28 North, Range 41 East, W.M., in Stevens County, Washington.

Parcel B 5156400:
The S1/2 of the N1/2 of the NE1/4 of the NW1/4 of Section 28, Township 28 North, Range 41 East, W.M., in Stevens County, Washington.

Parcel C 5156600:
The NW1/4 of the NW1/4 of Section 28, Township 28 North, Range 41 East, W.M., in Stevens County, Washington.
EXCEPT the E1/2 of the E1/2 of the S1/2 of the NW1/4 of the NW1/4 of said Section 28.

Parcel D 5156700:
The N1/2 of the N1/2 of the SW1/4 of the NW1/4 of Section 28, Township 28 North, Range 41 East, W.M., in Stevens County, Washington.

Parcel E 5157600:
The NE1/4 of the NE1/4 of Section 29, Township 28 North, Range 41 East, W.M., in Stevens County, Washington.

Parcel F 5157701:
The N1/2 of the SE1/4 of the NE1/4 of Section 29, Township 28 North, Range 41 East, W.M., in Stevens County, Washington.

Abbreviated Legal: P/O NE1/4, 29 28-41 and P/O NW1/4, 28-28-41

Tax Parcel No.: 5156600 & 5157600 & 5156700 & 5157701 & 5156300 & 5156400

Property Address: 6821 Cummings Canyon Way, Nine Mile Falls, WA 99026

Seller: _____

Buyer: _____

Seller: _____

Buyer: _____

The address shown above is provided for information only, as a convenience for the

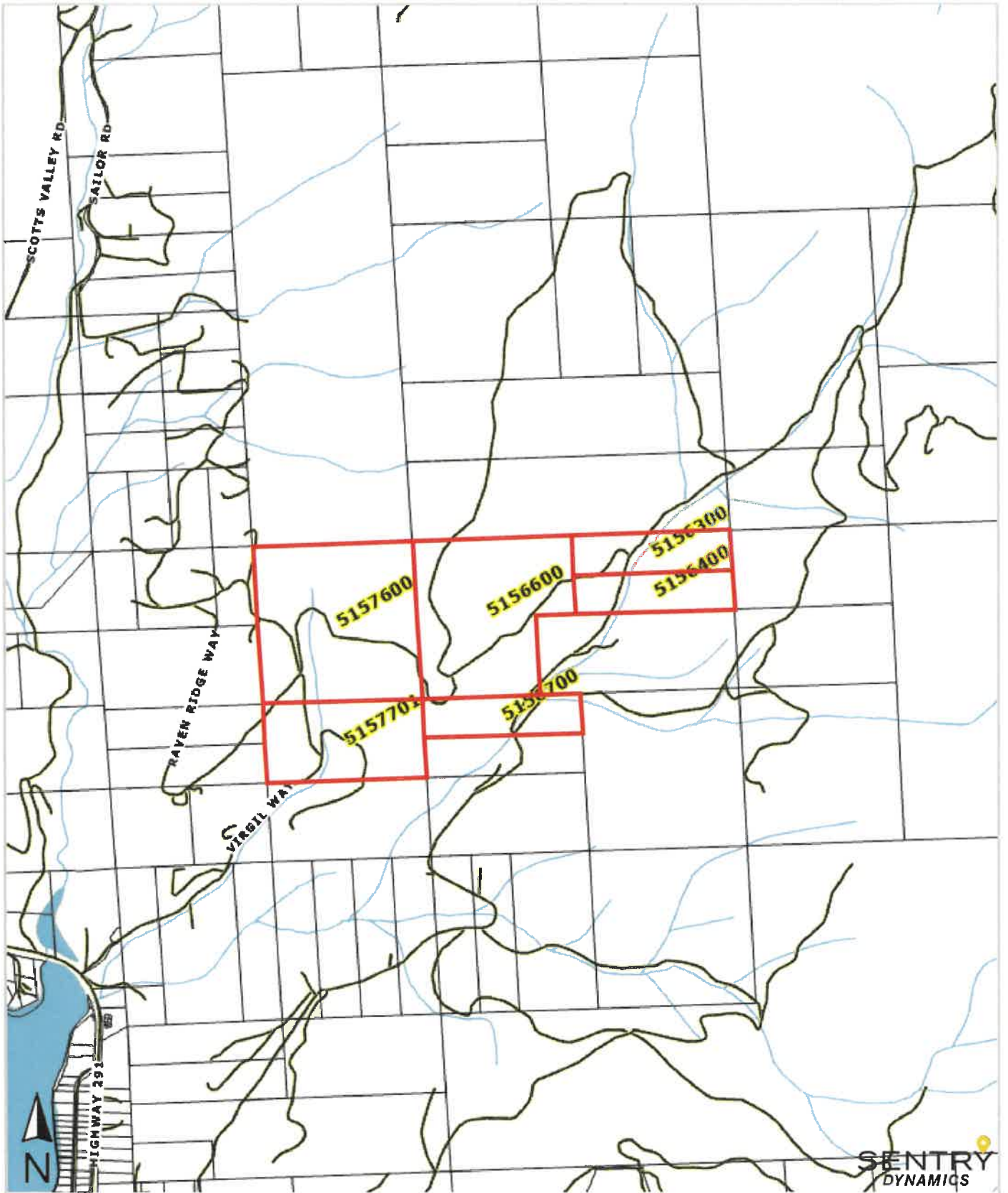

STEVENS COUNTY
TITLE & ESCROW

This map/plat is being furnished as an aid in locating the herein described land in relation to adjoining streets, natural boundaries and other land, and is not a survey of the land depicted. Except to the extent a policy of title insurance is expressly modified by endorsement, if any, the company does not insure dimensions, distances, location of easements, acreage or other matters shown thereon.