

NORTHEAST TRI COUNTY HEALTH DISTRICT
DIVISION OF ENVIRONMENTAL HEALTH

SR 171

ON-SITE SEWAGE SYSTEM PERMIT # PT0001686

Gary Brambrink is hereby authorized to utilize a sewage disposal system at
S2 SE4 NE4 SE4 SP 19-99-1

Section: 6 Township: 38 Range: 38 Parcel #: 1983410

in accordance with the plans and specifications approved by the District Health Officer on file in this office.

Prior to any major repairs, replacements or alterations to the system a permit shall be obtained from the NorthEast Tri County Health District (Division of Environmental Health).

This permit is issued and may be revoked by the NorthEast Tri County Health District Health Officer by authority of WAC 246-272, and Northeast Tri County Health District Regulations established by the Board of Health pursuant to RCW 70.05.

Additional permits from other jurisdictions or agencies may be necessary for this project. It is the responsibility of the applicant to acquire said permit(s), and comply with all applicable rules, regulations and/or ordinances.

Date Issued: 10/07/2005



District Health Officer

PERMIT INSTRUCTIONS

STRUCTURE TYPE: Single-Family Residential

DFLF/BED DIMENSIONS:200

NUMBER OF BEDROOMS: 3

TRENCH DEPTH (inches): 30

DESIGN FLOW (gal/day): 360

TENCH WIDTH (inches): 36

TYPE OF SYSTEM: New

APPURTANENCES: D-Box/Effluent filter

SYSTEM DESIGN: Gravity

PUMP CHAMBER (y/n): N

SEPTIC TANK CAPACITY (gal): 1000

PUMP CHAMBER GALLONS:

REASON SYSTEM DESIGN: Adequate soils

SPECIAL PERMIT INSTRUCTIONS:

FINAL INSPECTION DATE: 10/26/2005

Initials:



** SEE REVERSE FOR AS BUILT DRAWING

Stevens County Office
Pend Oreille County Office
Ferry County Office

P.O.Box 270
P.O. Box 490
P.O. Box 584

Colville,
Newport,
Republic,

WA 99114
WA 99156
WA 99166

(509) 684-2262
(509) 447-3131
(509) 775-3111

SR 171

NORTHEAST TRI COUNTY HEALTH DISTRICT
AS-BUILT DRAWING - PERMIT # PT0001686

INSPECTION DATE 10-26-05 INSPECTED BY MS APPROVED: YES NO

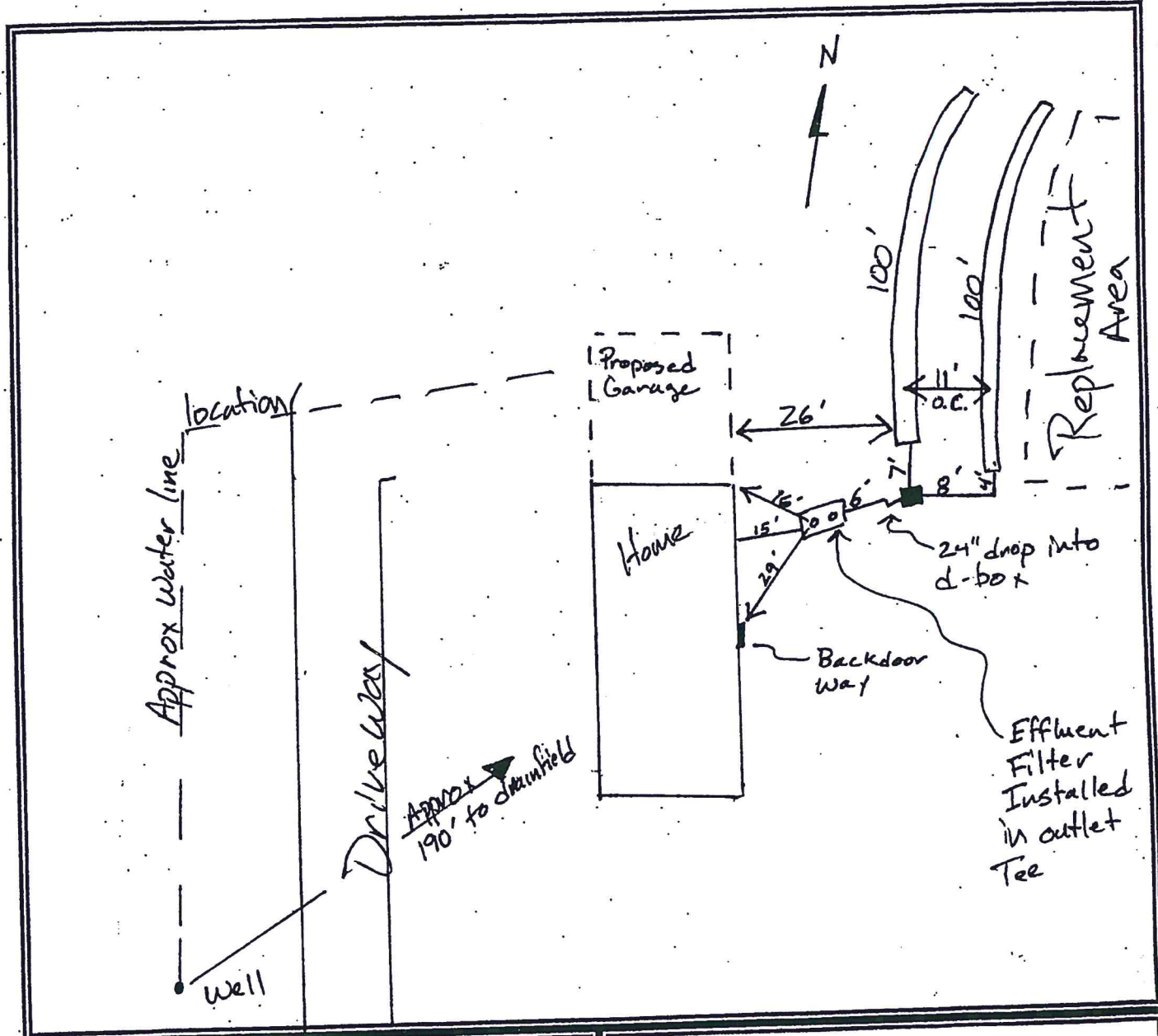

Installer Name Ron Hastings
 Septic Tank Size 1000 gallons
 Drainfield Length 200'
 Drainfield Depth 30"

Pump Chamber Size _____
 Doses/Day _____ Gallons/Dose _____
 Squirt Height _____ Drawdown _____
 Pump Run Time _____

(Revised 7/2003)